

Executive Studio



CLICK TO VIEW THE
PROPERTY TOUR

About the Property

Infinity Place in Melbourne provides a home for students to achieve infinite success and possibilities whilst at university. Located on Berkeley Street, Infinity Place is just two trams stops from Melbourne Central, so you are perfectly located next to Melbourne University and the CBD.

Extensive leisure and social spaces in the property allow students to maintain a happy, healthy body and mind. Intended as an extension to the existing 'University Square' community located across the road, residents can enjoy the best of each building's facilities.

About the Room

Get to know our largest studio room at Infinity Place! At an average of approximately 26 sq.m. in size, there's plenty of room to move around your living space, dining area and fully equipped kitchen. These studios are located on all levels in the building, so we've got some Executive Studios with unbeatable city views too!



Room Features:

- A fully furnished room
- Individual study area
- A modern, ensuite bathroom
- Contemporary, full equipped kitchen
- Dining area
- Living area with TV
- Air-conditioning
- Average apartment size of 26 sq.m.
- Apartments located on Floors 1 to 19

Prices from \$499 a week, all bills included

Additional Room Options

- Executive Studio Lower - Floors 1 to 4
- Executive Studio City Views - Floors 11 to 19
- Executive Studio with Terrace - Floors 1 to 10
- Executive Studio with Terrace Upper - Floors 11 to 17

Infinity Place

- <https://thestudenthousingcompany.com.au/locations/melbourne/infinity-place/>
- Infinity Place, 145 Berkeley St, Melbourne VIC 3000, Australia
- infinityplace@thestudenthousingcompany.com.au
- + 61 (0)3 9052 3202

THE
STUDENT
HOUSING
COMPANY

Executive Studio

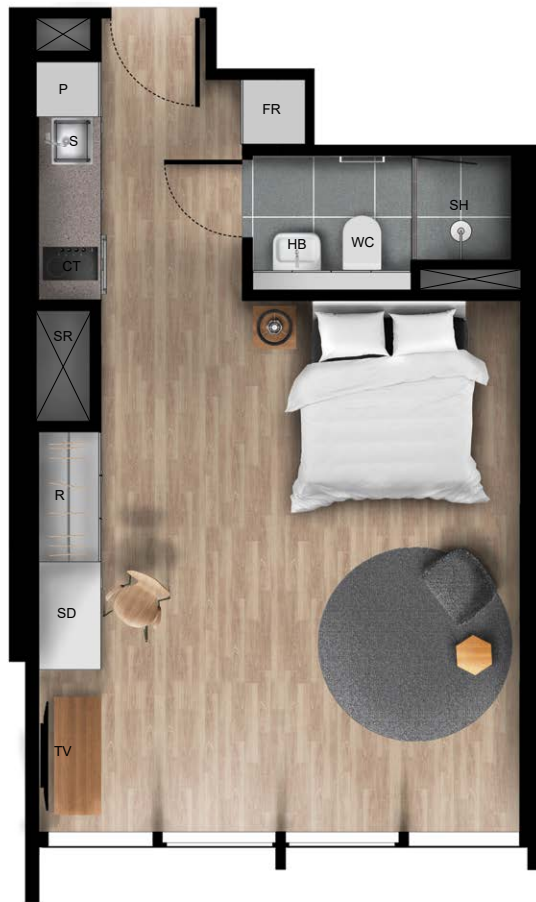

Average apartment size of 26 sq.m.

Property Features:

- High speed internet and Wi-Fi
- 24-hour CCTV security and
- Residence team
- Central location
- On-site maintenance team
- On-site laundry
- On site gymnasium
- Cinema room
- Two outdoor terraces
- Communal kitchen and dining area
- Study room and social spaces
- Games room
- Secure bike storage
- Secure post and parcel storage

[Book your room](#)

Infinity Place

- <https://thestudenthousingcompany.com.au/locations/melbourne/infinity-place/>
- Infinity Place, 145 Berkeley St, Melbourne VIC 3000, Australia
- infinityplace@thestudenthousingcompany.com.au
- + 61 (0)3 9052 3202

THE
STUDENT
HOUSING
COMPANY

Executive Studio with Terrace

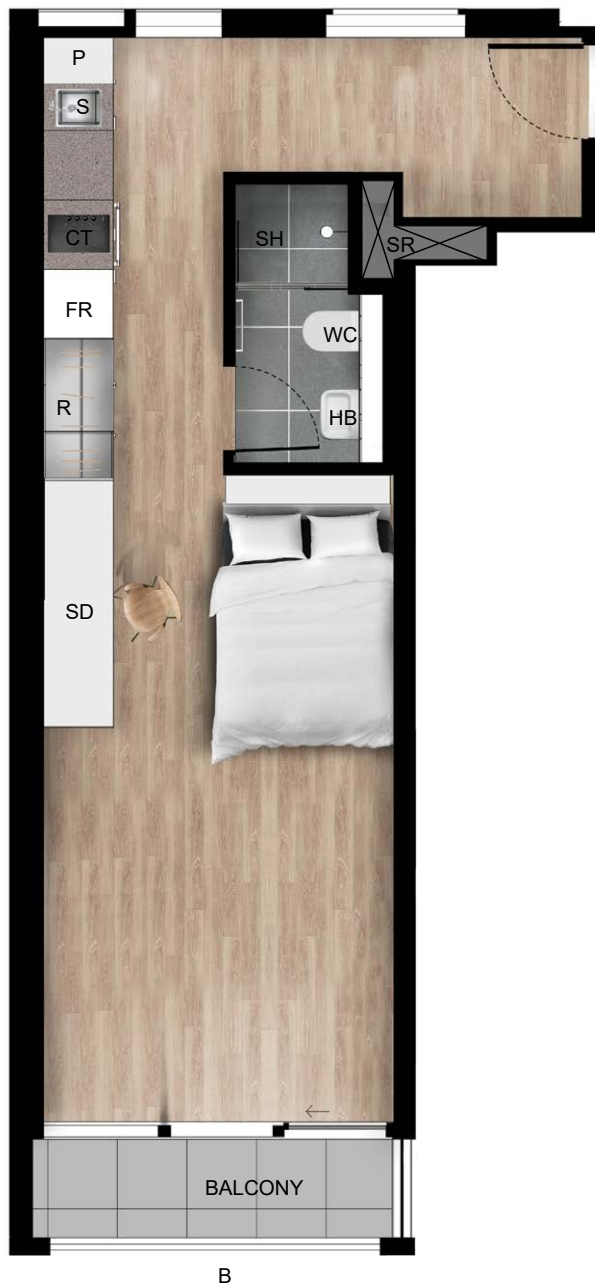

[Book your room](#)

Infinity Place

- <https://thestudenthousingcompany.com.au/locations/melbourne/infinity-place/>
- Infinity Place, 145 Berkeley St, Melbourne VIC 3000, Australia
- infinityplace@thestudenthousingcompany.com.au
- + 61 (0)3 9052 3202

THE
STUDENT
HOUSING
COMPANY

Executive Studio

Why should I choose this room?

Sometimes you just want some space to yourself to enjoy your own company. If this resonates with you, the Executive Studio would be a great match for you. The comfortable design of the Executive Studio creates the perfect space to relax and unwind after a long day of classes. With a little more space in the living and dining area,

this room is perfect if you like to invite your friends over for dinner or just to watch some Netflix.

What also makes the Executive Studio great is that there are a few different options available to you. Firstly, we have Executive Studios with terraces – which are ideal for relaxing in the sun on your days off. Infinity Place

also has Executive Studios with panoramic views of the Melbourne CBD – so book these quickly if you want a room with a view that is Instagram worthy every day of the year!

Some of our Executive Studios have a view into our lightwell at Infinity Place. To find out more about our lightwell, talk to our team or visit our display suite!



Not what you're looking for?

If you're not looking for extra space, then get to know our smaller sized studios – the [Premium Studio](#) and [Studio with Terrace](#) are both 20 sq.m. in size but still come with all the same features.

Or perhaps you'd rather share an apartment with some fellow TSHC students? Read about our [3 Bed](#), [3 Bed Ensuite](#) and [6 Bed Townhouse](#) apartments. These apartments are made for social butterflies who always love having other people around.

Want to know more? Talk to us!

If you have any more questions, feel free to contact us or come [take a tour of our building Infinity Place!](#)

[Book your room](#)

Infinity Place

<https://thestudenthousingcompany.com.au/locations/melbourne/infinity-place/>

Infinity Place, 145 Berkeley St, Melbourne VIC 3000, Australia

infinityplace@thestudenthousingcompany.com.au

+ 61 (0)3 9052 3202

THE
STUDENT
HOUSING
COMPANY